

Produktbeskrivelse

Gummiskive med og uden stålindsats. Standard udgaven er i naturgummi og stålet el-galvaniseret. Kan også bestilles som følger:

- Gummihårdhed: 45, 55 & 70 IRHD
- Gummitype CR, EPDM & Silicone m.f.
- Gummiet kan farves
- AISI 316

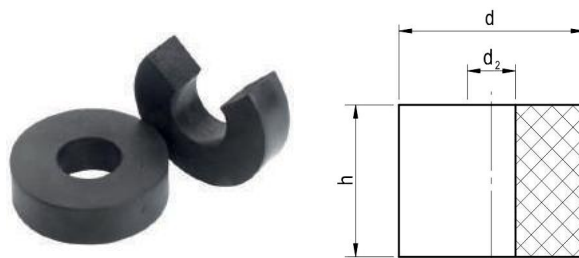

GS gummiskive

Type	d [mm]	h [mm]	d ₂ [mm]	GS	GS1	GS2
GS 008003-03	8	3,5	3,2	*		
GS 010008-04	10	8	4,3	*		
GS 013012-06	13	12	6,5	*		
GS 015012-06	15	12	6,5	*	*	
GS 015015-06	15	15	6,5	*	*	
GS 015020-06	15	20	6,5	*	*	
GS 015025-06	15	25	6,5	*	*	*
GS 017016-09	17,5	16	9	*		
GS 019019-13	19	19	13	*		
GS 020015-08	20	15	8,5	*	*	
GS 020020-08	20	20	8,5	*	*	
GS 020025-06	20	25	6			*
GS 020025-08	20	25	8,5	*	*	
GS 020030-08	20	30	8,5	*	*	
GS 020040-08	20	40	8,5	*	*	
GS 025015-10	25	15	10,5	*		
GS 025020-06	25	20	6,6			*
GS 025020-10	25	20	10,5	*	*	
GS 025025-10	25	25	10,5	*	*	
GS 025030-10	25	30	10,5	*	*	
GS 025040-10	25	40	10,5	*	*	
GS 028016-08	28	16	8	*		
GS 028050-10	28	50	10,5	*		
GS 030015-16	30	15	16			*
GS 030030-13	30	30	13,5	*	*	
GS 030040-13	30	40	13,5	*	*	
GS 030050-13	30	50	13,5	*	*	
GS 032032-13	32	32	13,5	*		
GS 035015-19	35	15	19			*
GS 035020-13	35	20	13			*
GS 040009-17	40	9	17,5			*
GS 040010-10	40	10	10		*	
GS 040020-13	40	20	13			*
GS 040025-12	40	25	12	*		
GS 040030-01	40	30	0,9	*		
GS 040030-13	40	30	13,5	*	*	*

Type	d [mm]	h [mm]	d ₂ [mm]	GS	GS1	GS2
GS 040030-17	40	30	17	*		
GS 040032-13	40	32	13,5	*		
GS 040035-12	40	35	12	*		
GS 040040-13	40	40	13,5	*	*	*
GS 040040-16	40	40	16	*		
GS 040050-13	40	50	13,5	*	*	
GS 040060-13	40	60	13,5	*	*	
GS 040065-12	40	65	12	*		
GS 047050-20	47	50	20	*		
GS 048100-17	48	100	17	*		
GS 050013-16	50	13	16,5			*
GS 050015-21	50	15	21			*
GS 050020-17	50	20	17			*
GS 050025-11	50	25	11			*
GS 050025-13	50	25	13			*
GS 050025-17	50	25	17	*		
GS 050030-10	50	30	10			*
GS 050030-17	50	30	17			*
GS 050030-21	50	30	21			*
GS 050032-17	50	32	17	*		
GS 050038-20	50	38	20	*		
GS 050040-17	50	40	17	*	*	*
GS 050045-10	50	45	10	*		
GS 050050-17	50	50	17	*	*	*
GS 050050-24	50	50	24	*		
GS 050050-25	50	50	24,8	*		
GS 050060-17	50	60	17	*	*	
GS 050063-17	50	63	17	*		
GS 050080-14	50	80	14	*		
GS 050080-17	50	80	17	*	*	
GS 053100-32	53	100	32,5	*		
GS 058100-17	58	100	17	*		
GS 060013-20	60	13	20,5			*
GS 060030-10	60	30	10,5			*
GS 060030-17	60	30	17	*	*	
GS 060030-18	60	30	18			*

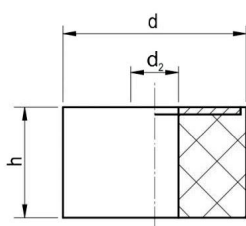

GS1 gummiskive med
1 stål indsats

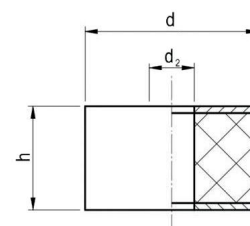

GS2 gummiskive med
2 stål indsatser

Type	d [mm]	h [mm]	d ₂ [mm]	GS	GS1	GS2
GS 060030-21	60	30	21			*
GS 060040-17	60	40	17	*	*	
GS 060040-20	60	40	20	*		
GS 060050-17	60	50	17	*	*	
GS 060050-21	60	50	21			*
GS 060060-17	60	60	17	*	*	
GS 062006-14	62	6	14		*	
GS 070040-40	70	40	40	*		
GS 075030-25	75	30	25			*
GS 075040-18	75	40	18	*		
GS 075055-25	75	55	25			*
GS 080027-20	80	27	20	*		
GS 080030-21	80	30	21	*	*	*
GS 080030-40	80	30	40	*		
GS 080035-30	80	35	30	*		
GS 080040-20	80	40	20	*		
GS 080040-21	80	40	21	*	*	
GS 080040-25	80	40	25	*		
GS 080050-15	80	50	15	*		
GS 080050-21	80	50	21	*	*	
GS 080060-21	80	60	21	*	*	
GS 080080-21	80	80	21	*	*	
GS 080082-25	80	82	25	*		
GS 080100-21	80	100	21	*		
GS 090045-30	90	45	30	*		
GS 100019-56	100	19	56		*	
GS 100030-21	100	30	21	*	*	
GS 100030-60	100	30	60		*	
GS 100035-30	100	35	30	*		
GS 100040-21	100	40	21	*	*	*
GS 100040-25	100	40	25	*	*	
GS 100040-26	100	40	26	*		
GS 100040-31	100	40	31			*
GS 100040-33	100	40	33	*		
GS 100040-70	100	40	70	*		

Type	d [mm]	h [mm]	d ₂ [mm]	GS	GS1	GS2
GS 100050-21	100	50	21	*	*	
GS 100060-21	100	60	21	*	*	*
GS 100070-25	100	70	25	*		
GS 100070-40	100	70	40	*		
GS 100075-33	100	75	33	*	*	*
GS 100080-21	100	80	21	*	*	
GS 100100-21	100	100	21	*	*	
GS 120030-21	120	30	21		*	
GS 120040-25	120	40	25	*	*	
GS 120040-40	120	40	40	*		
GS 120040-41	120	40	41			*
GS 120040-50	120	40	50	*		
GS 120040-51	120	40	51			*
GS 125080-35	125	80	35			*
GS 125125-35	125	125	35	*		*
GS 125125-50	125	125	50	*		
GS 150040-32	150	40	32		*	
GS 150100-51	150	100	51	*		*
GS 150180-45	150	180	45	*		
GS 160160-33	160	160	33	*		
GS 200100-32	200	100	32			*
GS 200100-61	200	100	61	*		*
GS 200200-33	200	200	33	*		
GS 250200-60	250	200	60	*		