

Product description

FDR mounts are designed for applications where the transmission of low-frequency mechanical vibrations to a building structure needs reducing to prevent building damage or nuisance to residents.

The FDR mount is also designed to limit vertical movement when the mount unloads and has an upward motion. Its movement is limited by the stop's settings so that damage to the pipe connections is avoided.

The installation rests directly on the top plate and the height is adjusted by turning F, which presses down a plate which compresses the springs.



Application

Used for chillers, cooling towers, ventilation systems, compressor systems, pumps, blowers, and similar devices which have pipe connections which may be affected by large vertical shear of the system. The vertical movement can also occur during maintenance and renovation of pumps or motors on inertia foundations.

FDR2 & FDR4

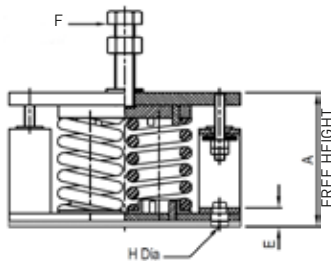

FDR2 with 2 spring variants

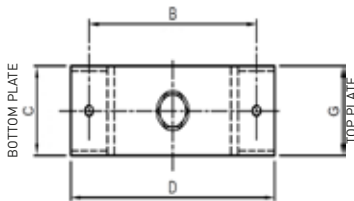

FDR4 with 2 spring variants

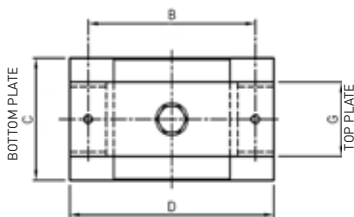

| Type | Deflection [mm] | Max. load [kg] | Colour | Dimensions [mm] | | | | | | | | Max. weight [kg] |
|--------------|-----------------|----------------|--------|-----------------|-----|-----|-----|----|-----------|-----|-----|------------------|
| | | | | A | B | C | D | E | F | G | H | |
| FDR2-0200-25 | 25 | 200 | Yellow | 160 | 230 | 100 | 280 | 22 | M24 x 100 | 100 | M16 | 12.4 |
| FDR2-0400-25 | | 400 | Red | | | | | | | | | |
| FDR2-0600-25 | | 600 | Purple | | | | | | | | | |
| FDR2-0800-25 | | 800 | Grey | | | | | | | | | |
| FDR2-1000-25 | | 1000 | Orange | | | | | | | | | |
| FDR2-1200-25 | | 1200 | Brown | | | | | | | | | |
| FDR2-1600-25 | | 1600 | Black | | | | | | | | | |
| FDR2-2000-25 | | 2000 | Blue | | | | | | | | | |
| FDR2-0200-50 | | 50 | 200 | | | | | | | | | |
| FDR2-0400-50 | 400 | | Green | | | | | | | | | |
| FDR2-0600-50 | 600 | | Blue | | | | | | | | | |
| FDR2-0800-50 | 800 | | White | | | | | | | | | |
| FDR2-1000-50 | 1000 | | Red | | | | | | | | | |
| FDR4-0400-25 | 25 | 400 | Yellow | 160 | 230 | 165 | 280 | 22 | M24 x 100 | 100 | M16 | 16.4 |
| FDR4-0800-25 | | 800 | Red | | | | | | | | | |
| FDR4-1200-25 | | 1200 | Purple | | | | | | | | | |
| FDR4-1600-25 | | 1600 | Grey | | | | | | | | | |
| FDR4-2000-25 | | 2000 | Orange | | | | | | | | | |
| FDR4-2400-25 | | 2400 | Brown | | | | | | | | | |
| FDR4-3200-25 | | 3200 | Black | | | | | | | | | |
| FDR4-4000-25 | 4000 | Blue | | | | | | | | | | |
| FDR4-0400-50 | 50 | 400 | Yellow | 187 | 230 | 165 | 280 | 22 | M24 x 100 | 100 | M16 | 16.3 |
| FDR4-0800-50 | | 800 | Green | | | | | | | | | |
| FDR4-1200-50 | | 1200 | Blue | | | | | | | | | |
| FDR4-1600-50 | | 1600 | White | | | | | | | | | |
| FDR4-2000-50 | | 2000 | Red | | | | | | | | | |